

DR24/S

Door Retaining Magnet

Features:

- Operating voltage 12V DC
- White powder-coat finish
- Fire tested: EN1155
- Up to 80lbs (32kg) holding force
- Over-ride switch
- Surface mount

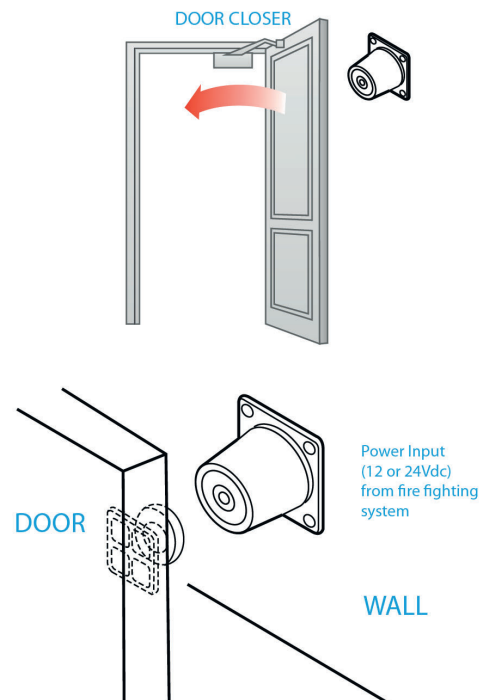
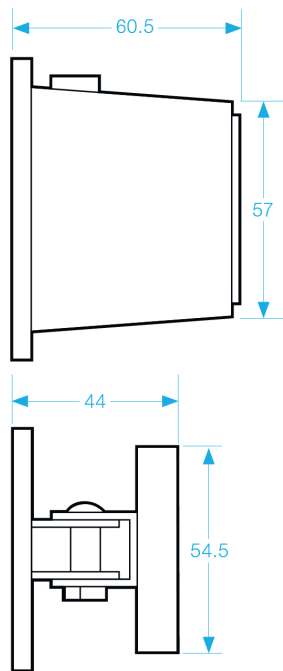
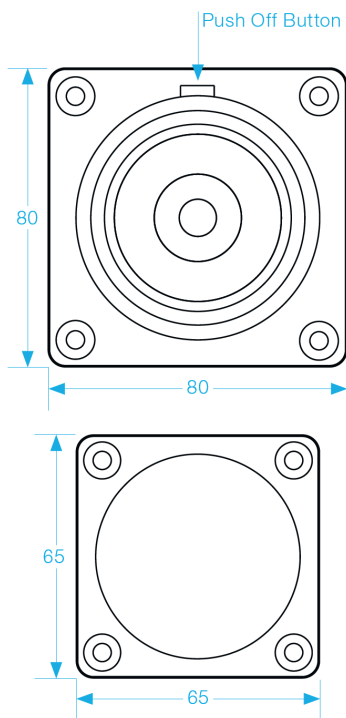

TECHNICAL DATA

	DR24/S
Voltage tolerance	±15%
Current draw	125mA at 12V DC, 60mA at 24V DC (at temperature 20°C)
Operating temperature	-10~45°C (14 to 131°F)
Humidity	0~95% non-condensing
Weight	380g (approx)